

Anti-theft lock DS 300

The anti-theft lock is used to secure swap bodies. It works by inserting the anti-theft lock into the twist lock opening in the corner casting.

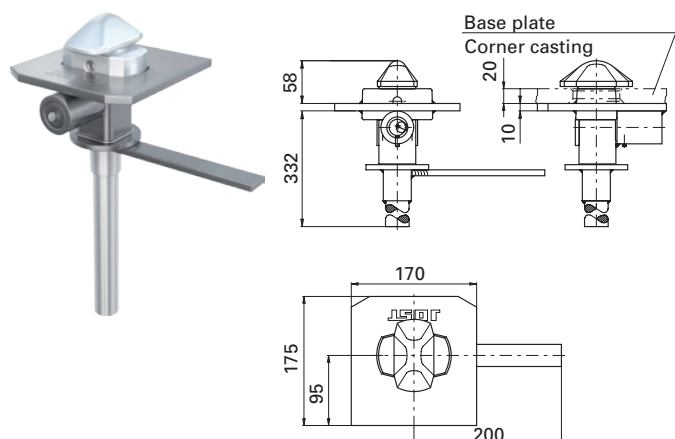

Housing: Steel construction (primed)

Locking pin: ø 38 mm (ISO)

Lock: Quality cylinder lock, protected from dust and water, for normal locking and locking systems.

Notes: Quote the code number for ordering additional keys or cylinder locks for locking systems.

Selection table/available versions

Weight (kg)	Order No.	Drawing No.
7.0	DS 300	905.406.000



Spanner for twist locks

The clamp nuts are released and tightened using the spanner.

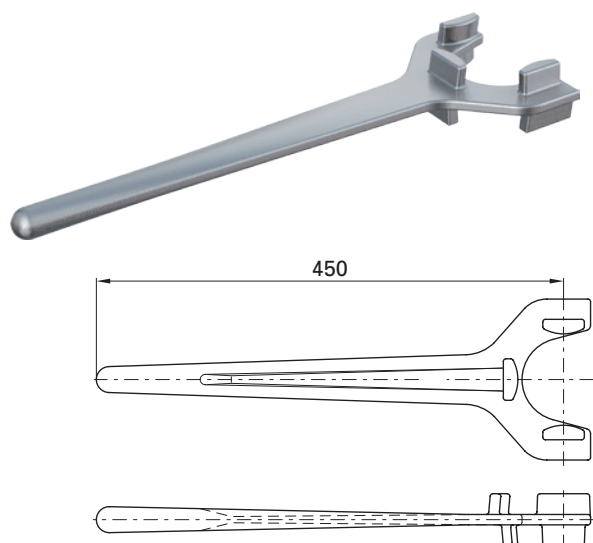

Type KH

Selection table/available versions

Application	Weight (kg)	Order No.
R 305 VAP (Type KH)	2.4	915.472.000
R 316 VAP (Type KH)	2.4	915.089.000
all others (Type Universal)	2.7	915.259.000

Type Universal

Designed to secure all locks except type R 305 VAP / R 316 VAP.

Installation tool for locking rings

The installation tools are used to install the locking rings for container twist locks.

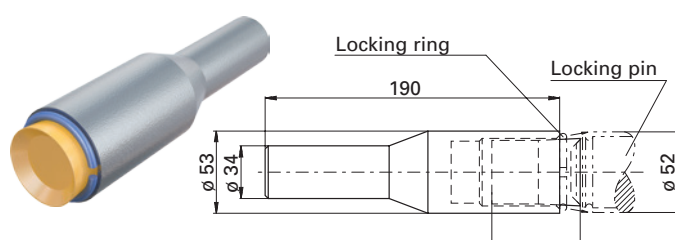

MW 52 for locking pin ø 52

Selection table/available versions

Application	Weight (kg)	Order No.
Locking pin ø 52	2.1	905.001.000
Locking pin ø 38	1.7	905.002.000